

**SPECIFICATIONS**

Description	Specification
Frequency Range	698 ~ 2700 MHz
Gain	3.5dBi
VSWR	< 1.5
Impedance	50 Ω
Polarization	Vertical
BW/Azimuth	360°
BW/Elevation	90°
PIM	>153dBc (43dBm x 2)
Connector	N (Female)
Dimensions	4" x 6" x 0.062" / 102 x 152 x 1.6 mm
Weight	50g / (0.4 lbs)
Temperature	-40°C ~ +80°C
Mounting	Ceiling Tile
Color	White

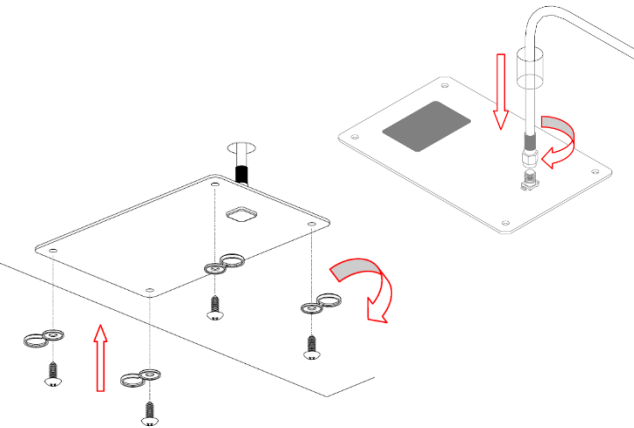

**FEATURES:**

This multi-band indoor ceiling mount antenna is used for distributing the wireless signal from a cellular in-building repeater system. Its ultra low-profile / stealth design blends in perfectly in high-end residential, office or hotel environments for an unobtrusive appearance. The radiating pattern of this antenna is omni directional. Therefore it is best installed in a centralized location on the ceiling of the area you hope to improve reception. The area of coverage from this antenna will vary in size when used in passive DAS environment. The input signal together with your link budget will determine what your final coverage area will be.

- Multi-Band (698~2700 MHz)
- Ultra - Low Profile Design
- Easily Attaches to Suspended Tiles or Sheetrock Ceiling
- Designed for DAS or Wi-Fi applications.